

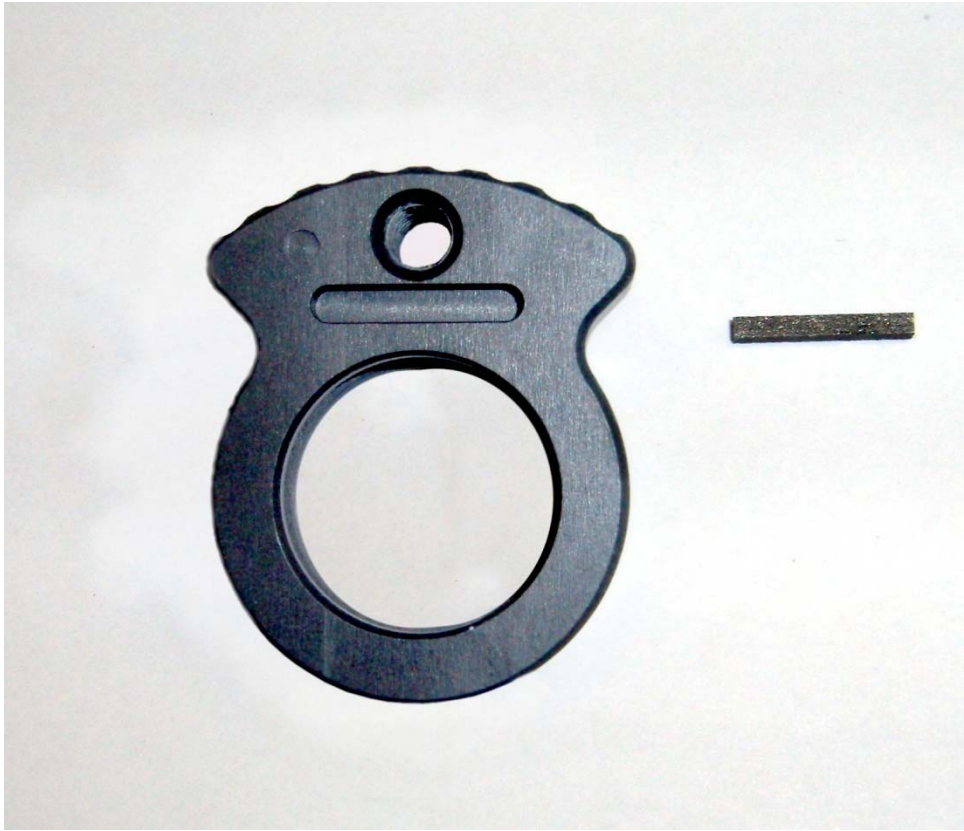

Service manual for
L197LED3-K PHANTOM™
and L197LED20-K PHANTOM™
dive lights.

To begin the assembly process,
epoxy the magnet into the *Actuator Switch*, and
let harden for 8 hours.







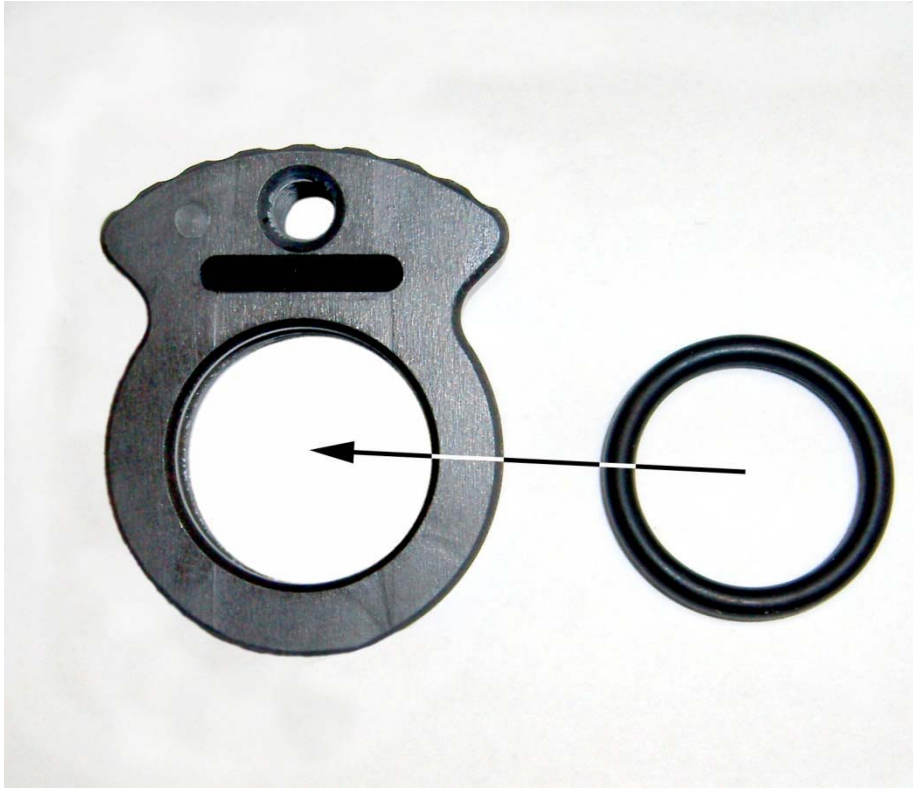

Place the flat washer over the hose support standoff, and apply grease to the washer.

Then, place the actuator switch over the hose support standoff, and push down using a twisting motion until the switch bottoms out. Next, insert the small thin *White Nylon Washer* on top.









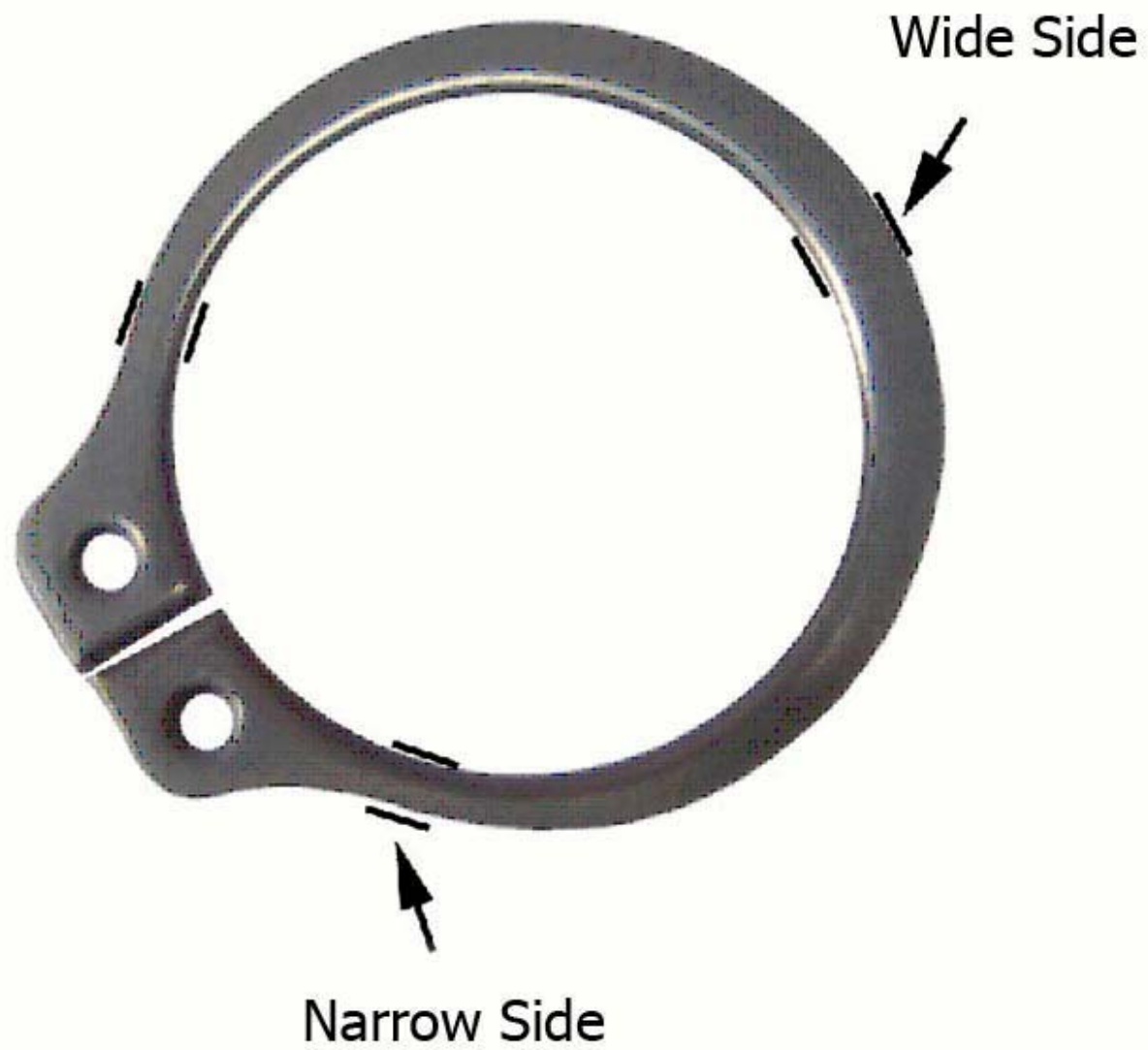















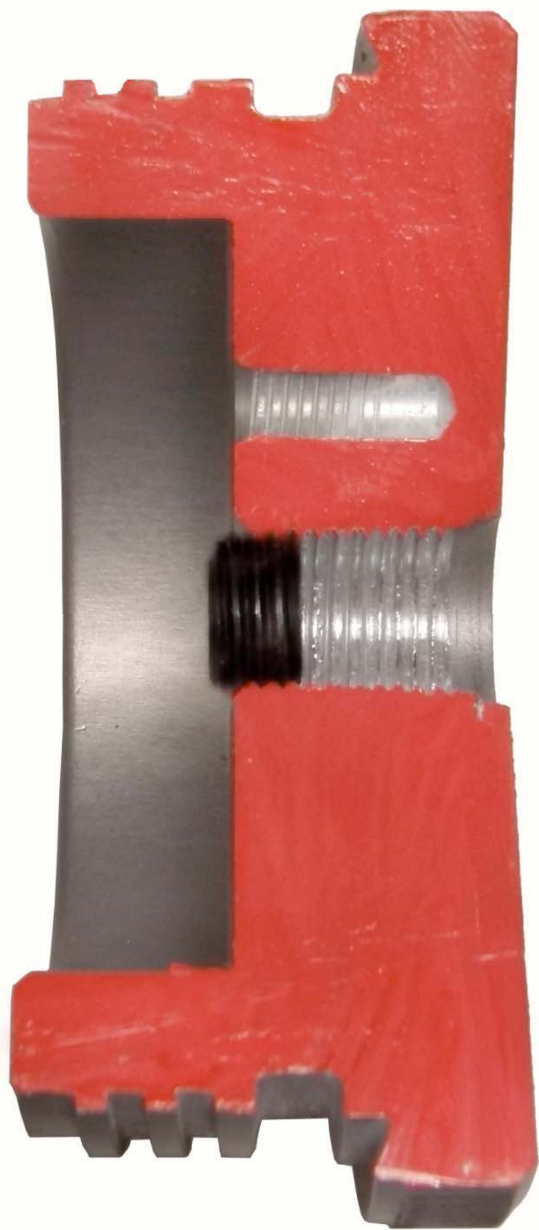

You will now be assembling the hose to the Light Head and the metal Canister End Cap. Before you start, apply a small amount of grease to the Light Head and End Cap O-Ring seating areas. These areas are where Hose O-Rings will seal. Lubricate both hose O-Rings, and then apply a small amount of Loctite #242 Blue (thread-locking fluid) to the threads. Do not get any on the O-Rings! (If you do, replace the O-Ring) and repeat the previous steps.



















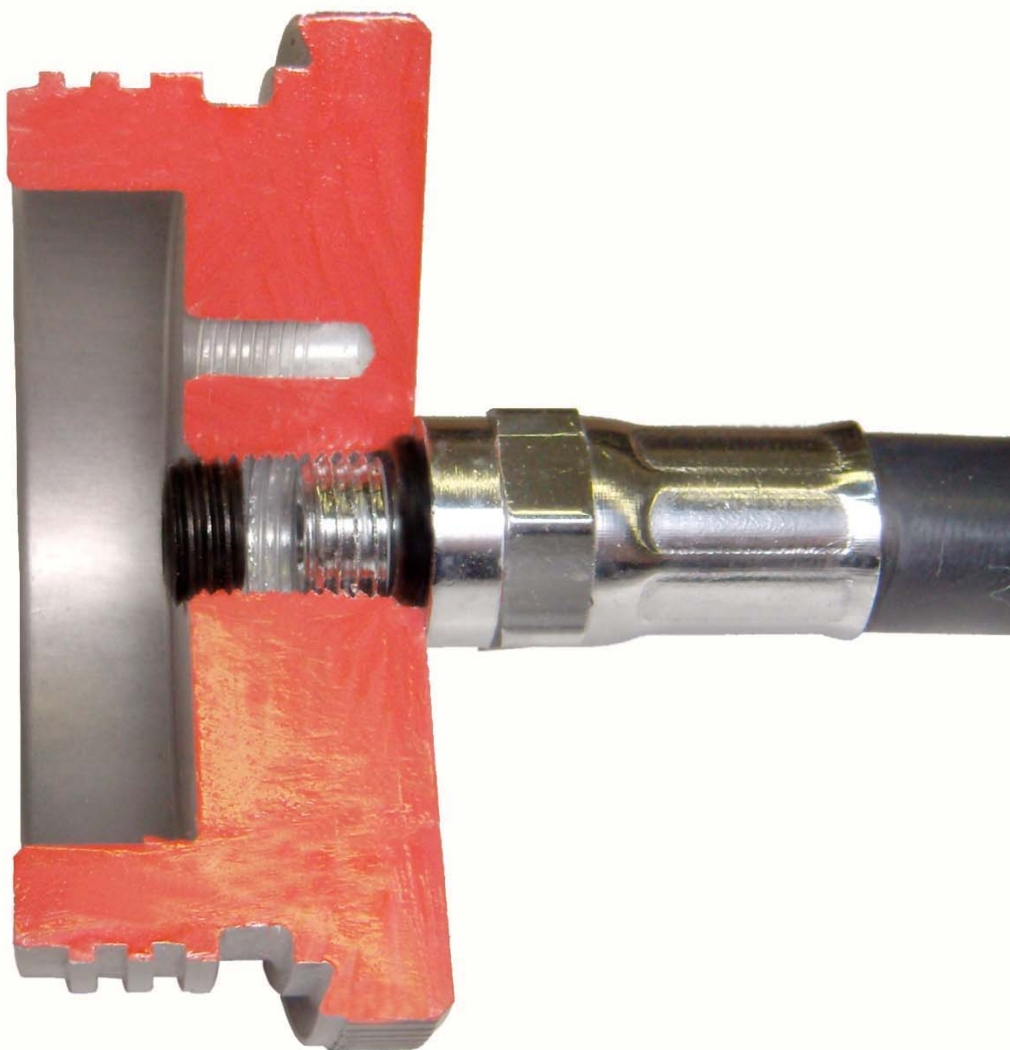



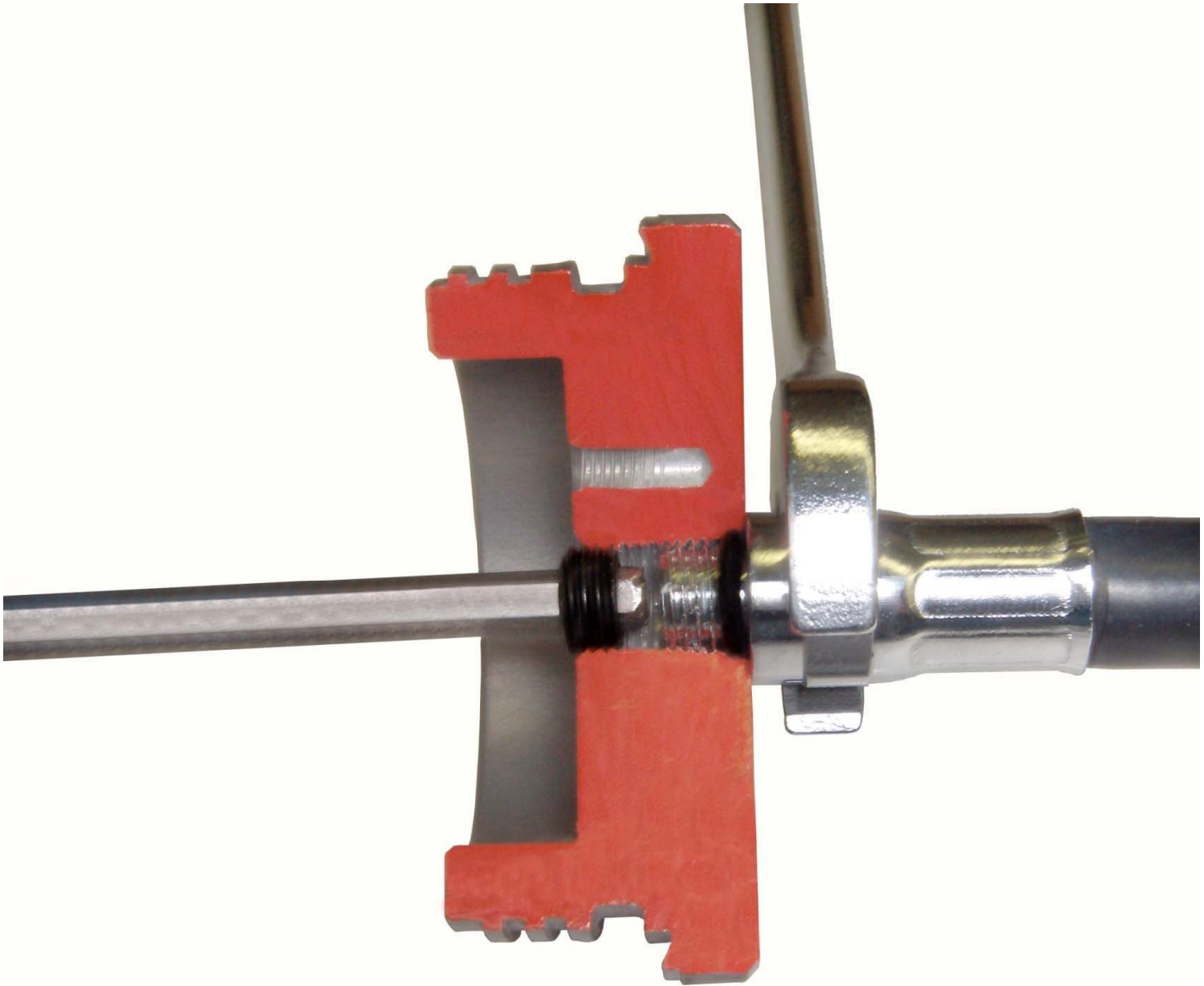



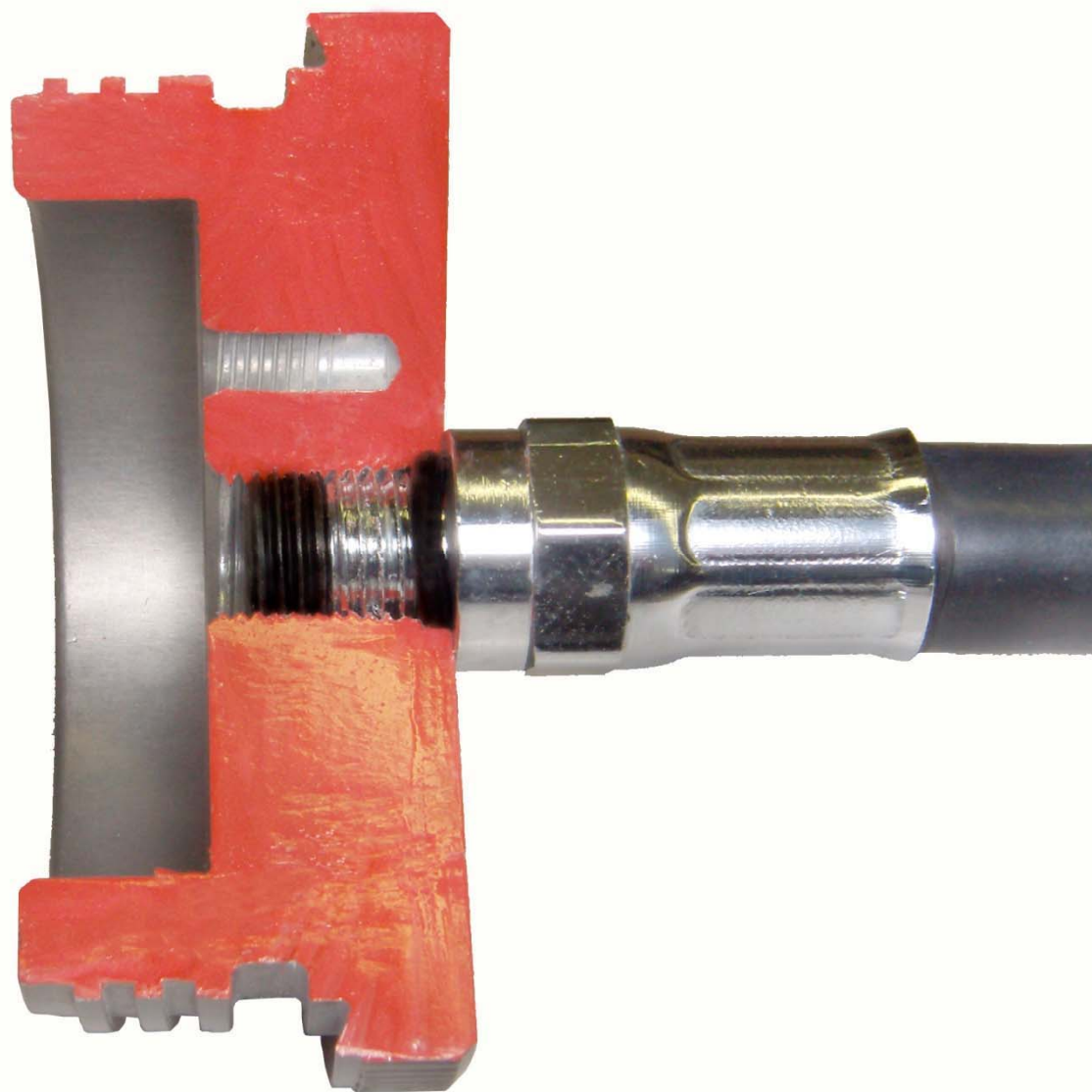



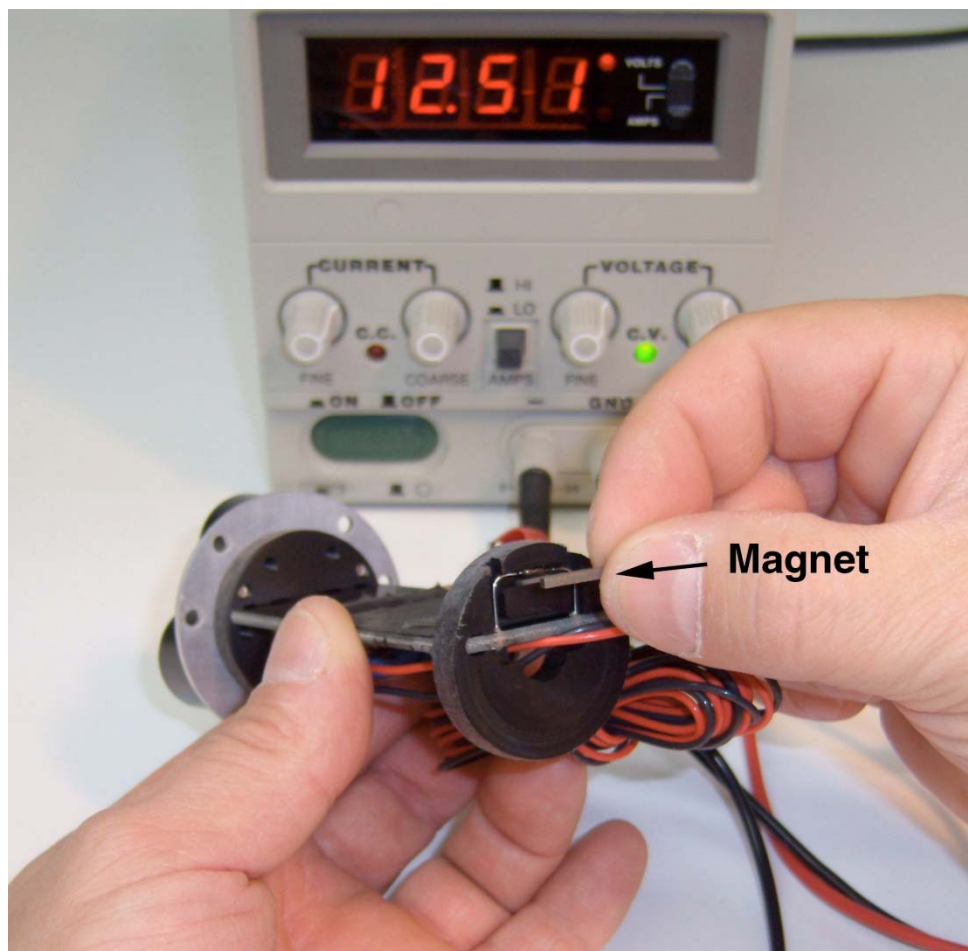

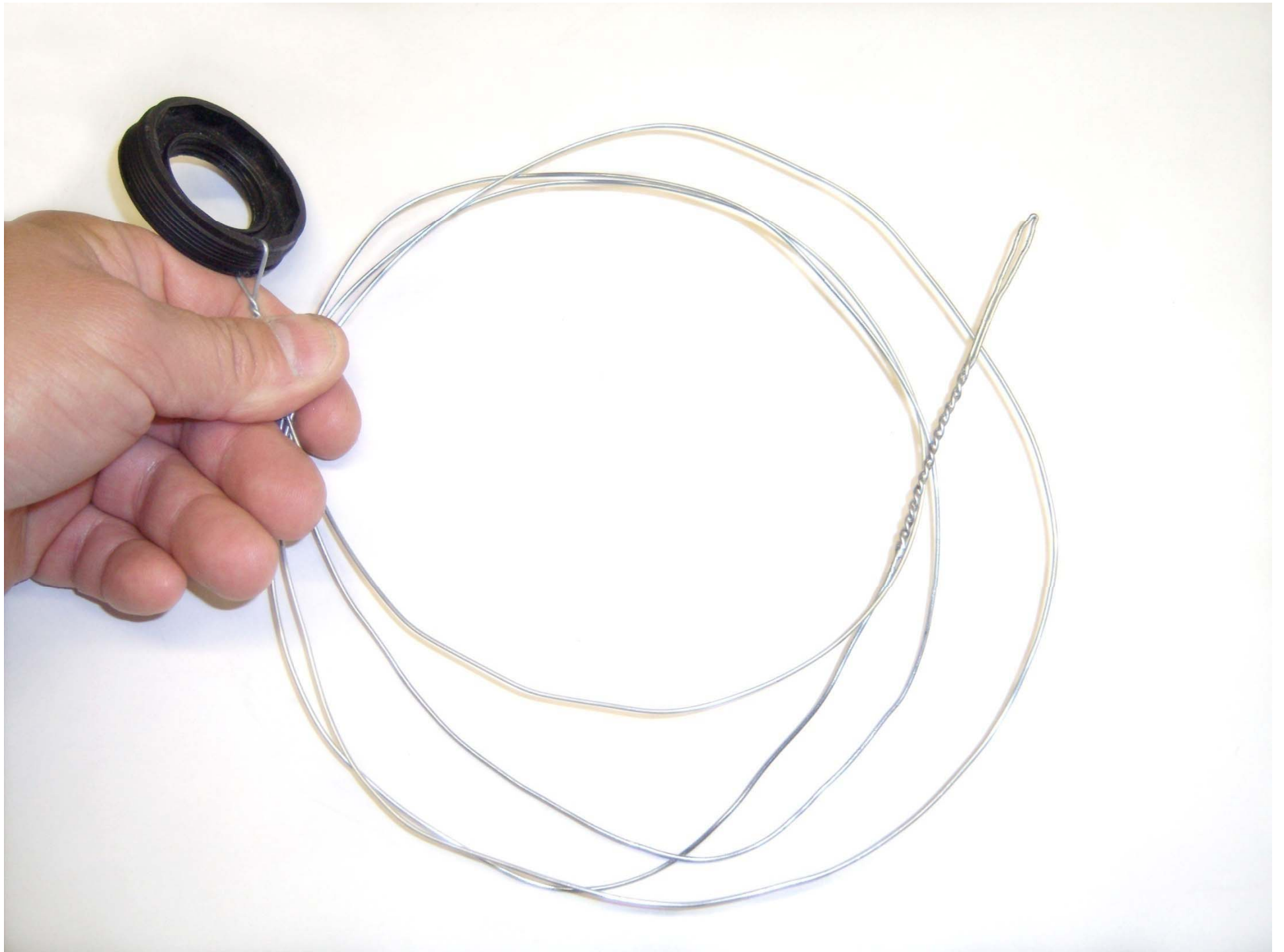



Remember to
secure the light
head.





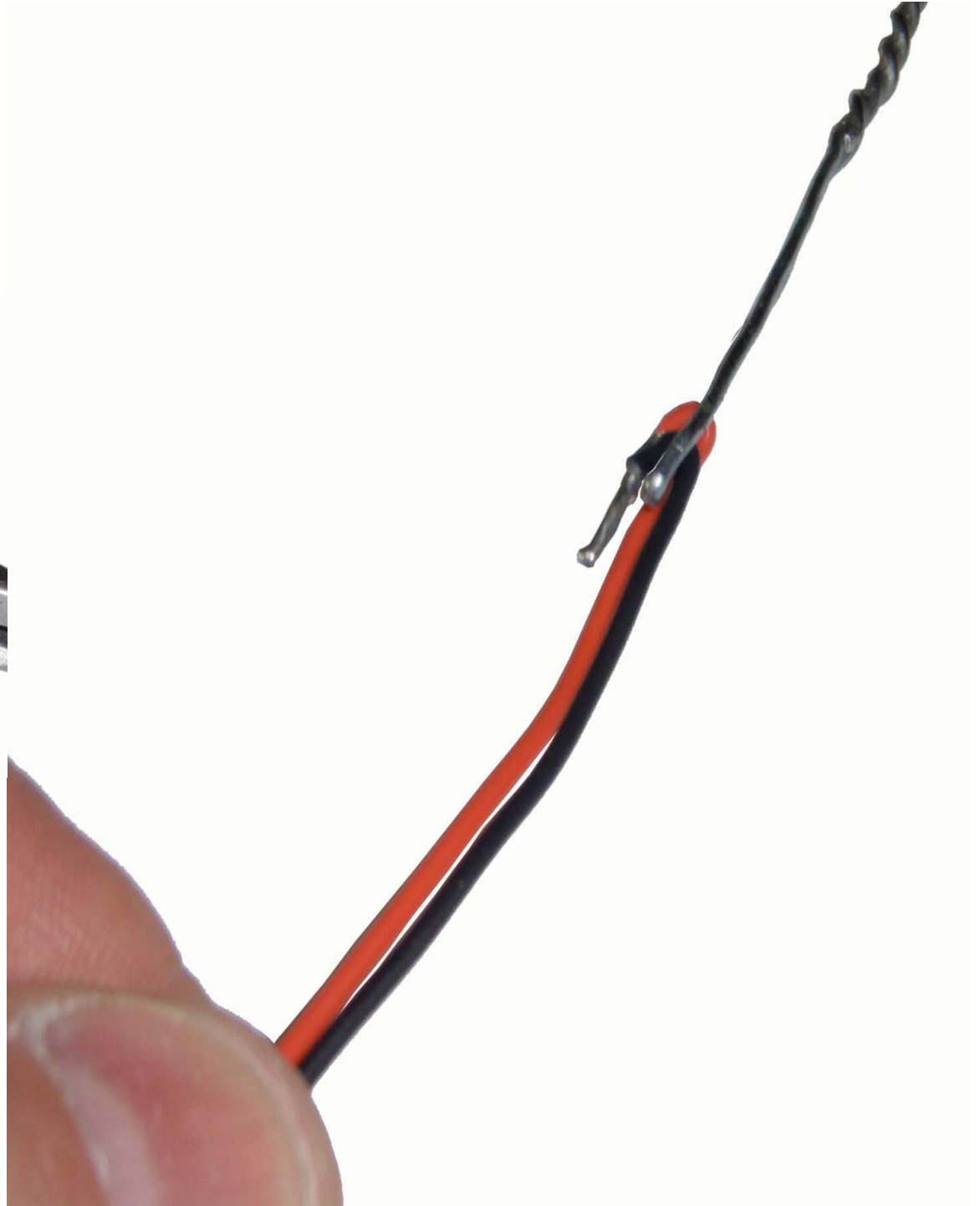
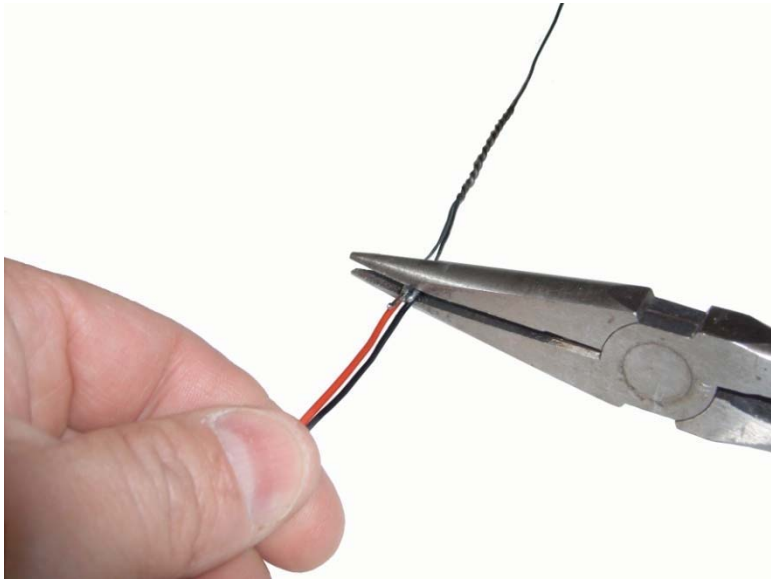



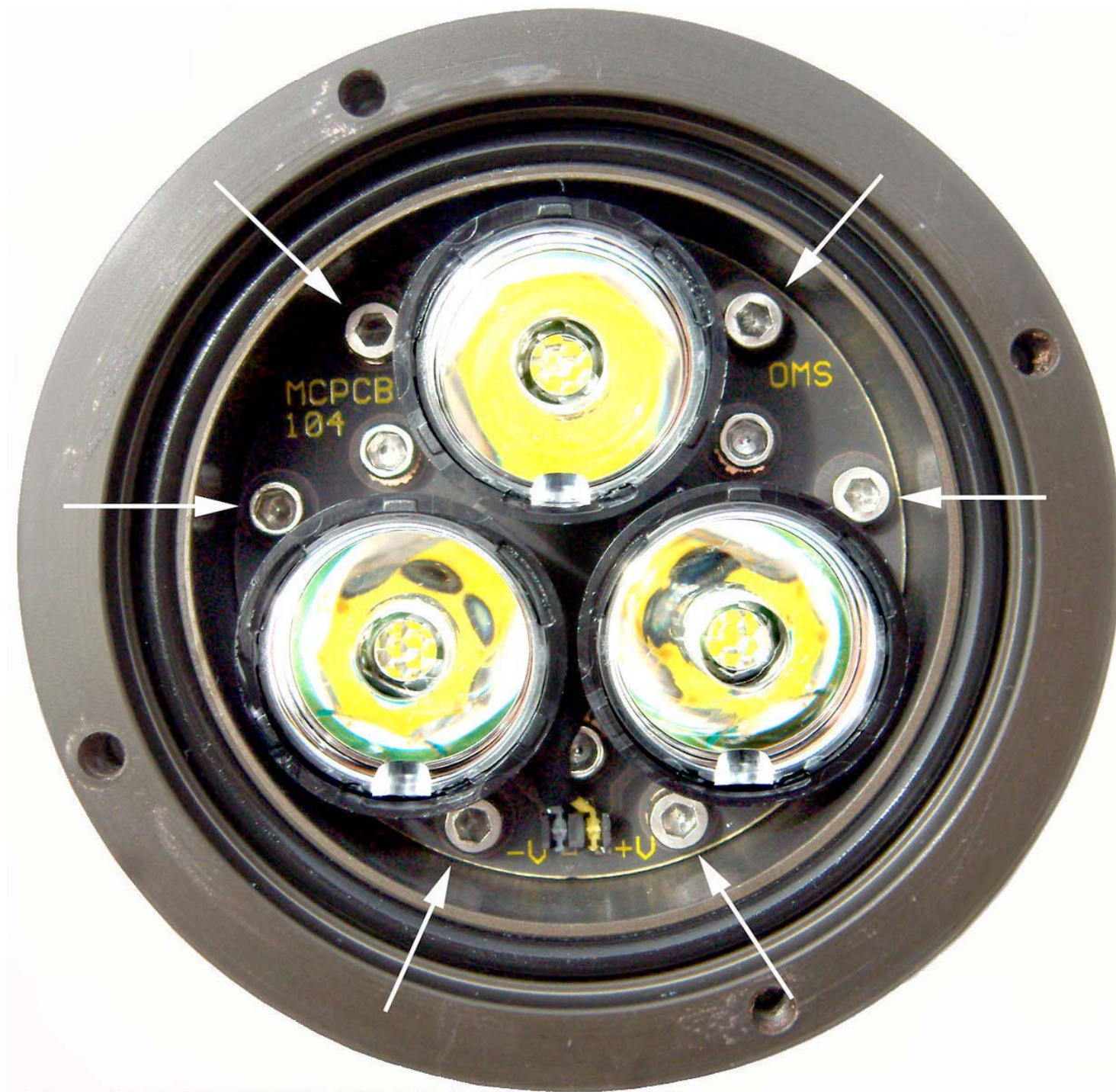







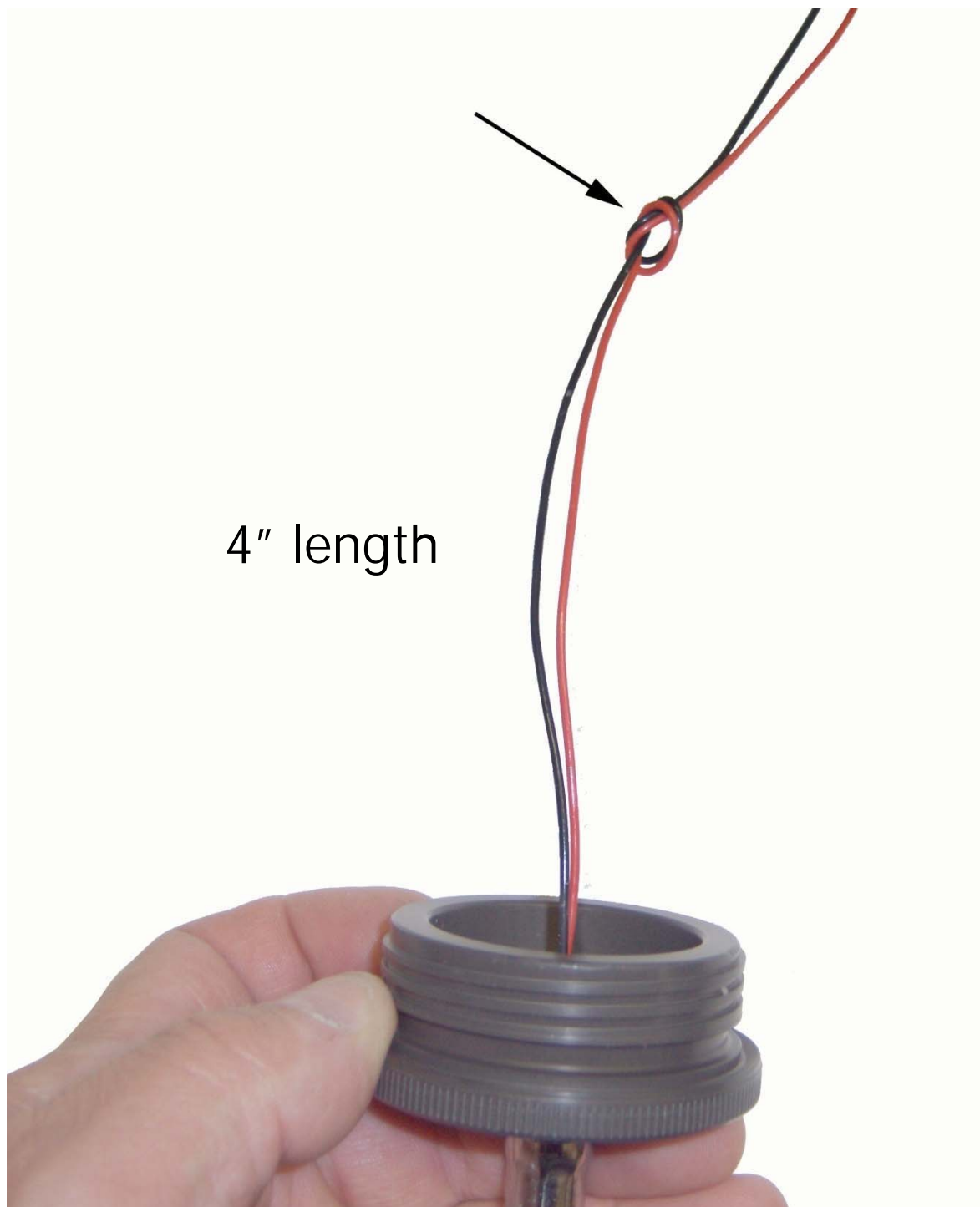

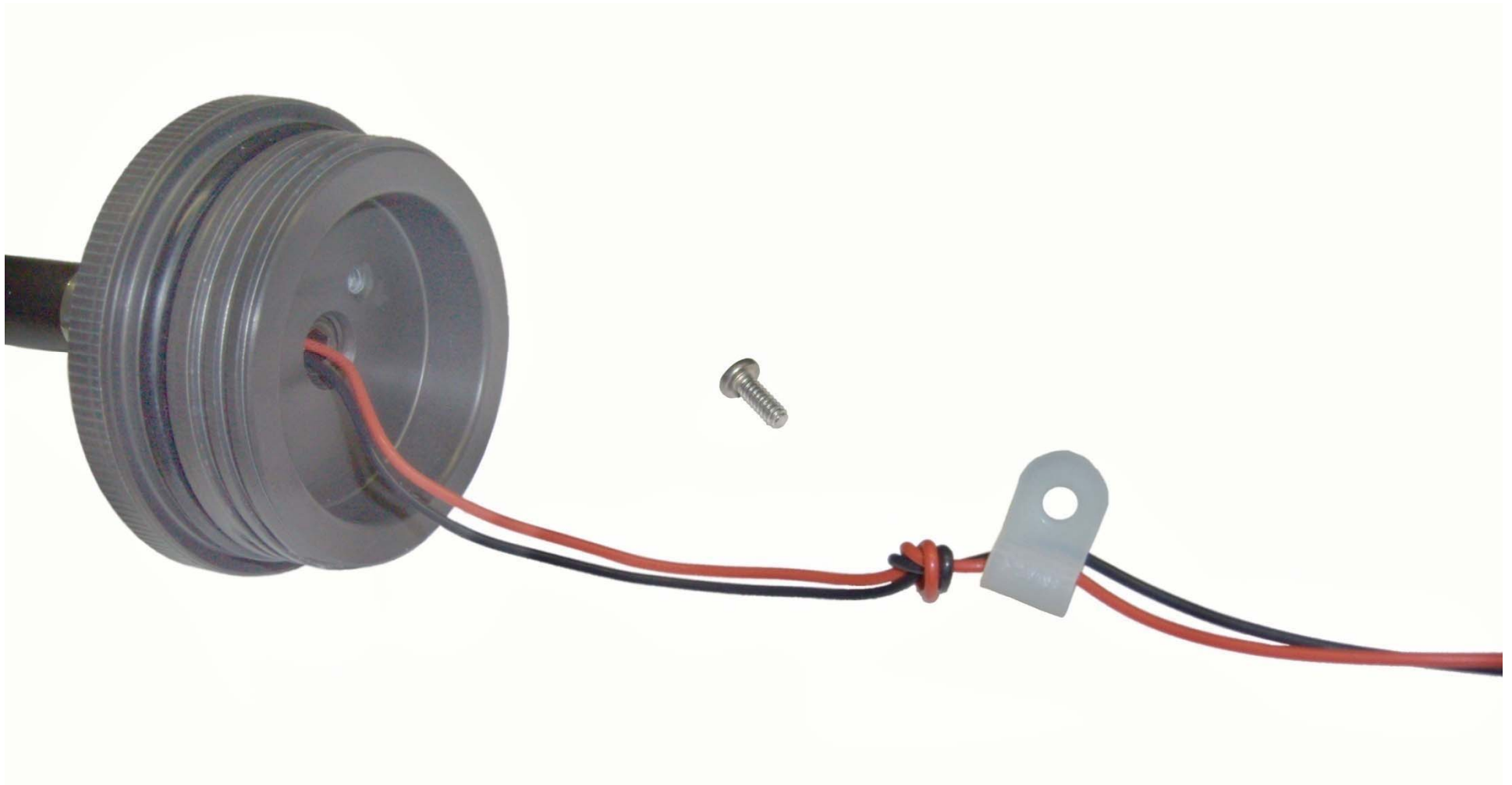





Next, place a lightly lubricated O-Ring in the groove of the metal end cap as shown.

Apply a light coat silicone grease on the canister area where this O-Ring will seat (above the canister threads) before screwing in the End Cap.

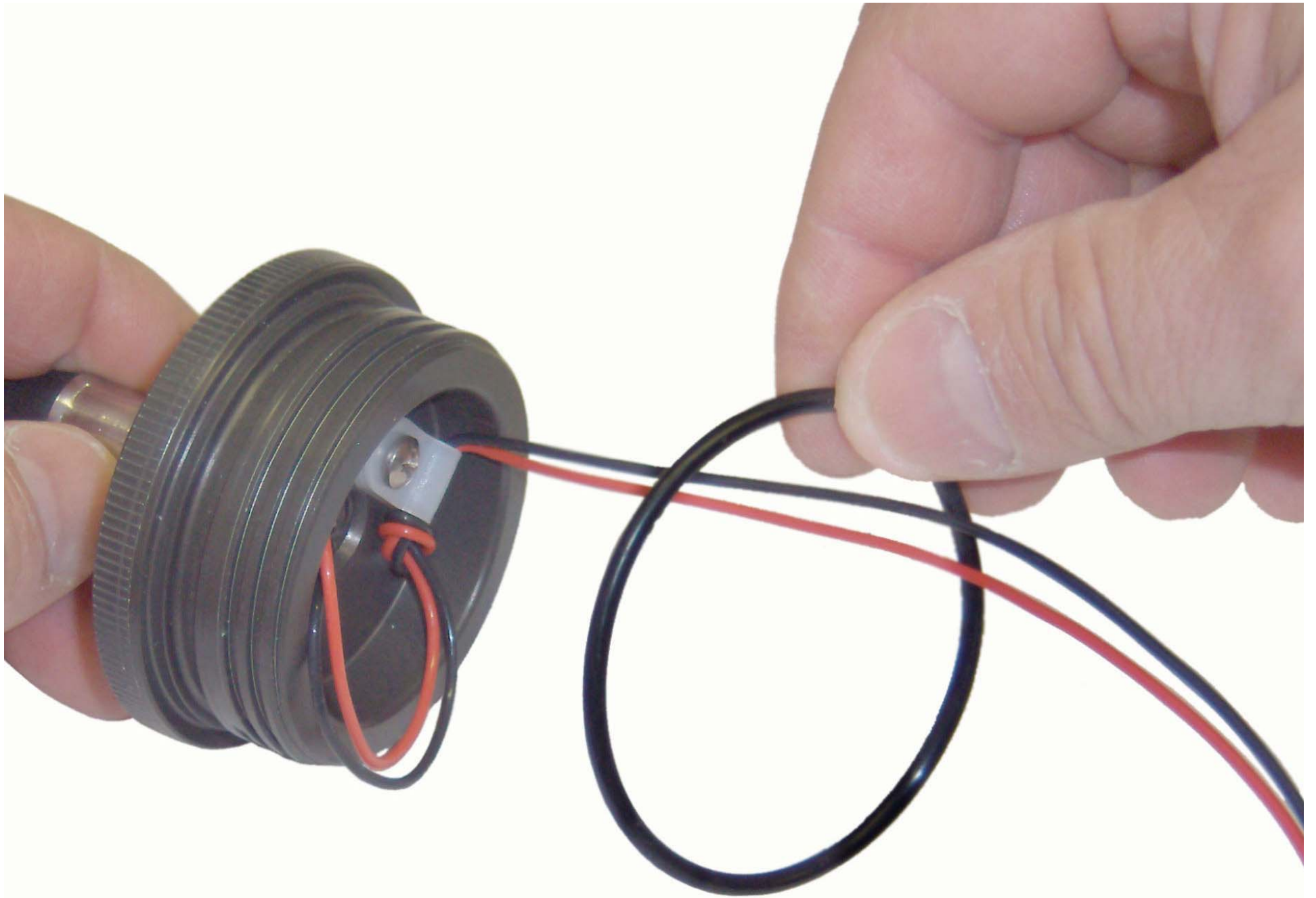





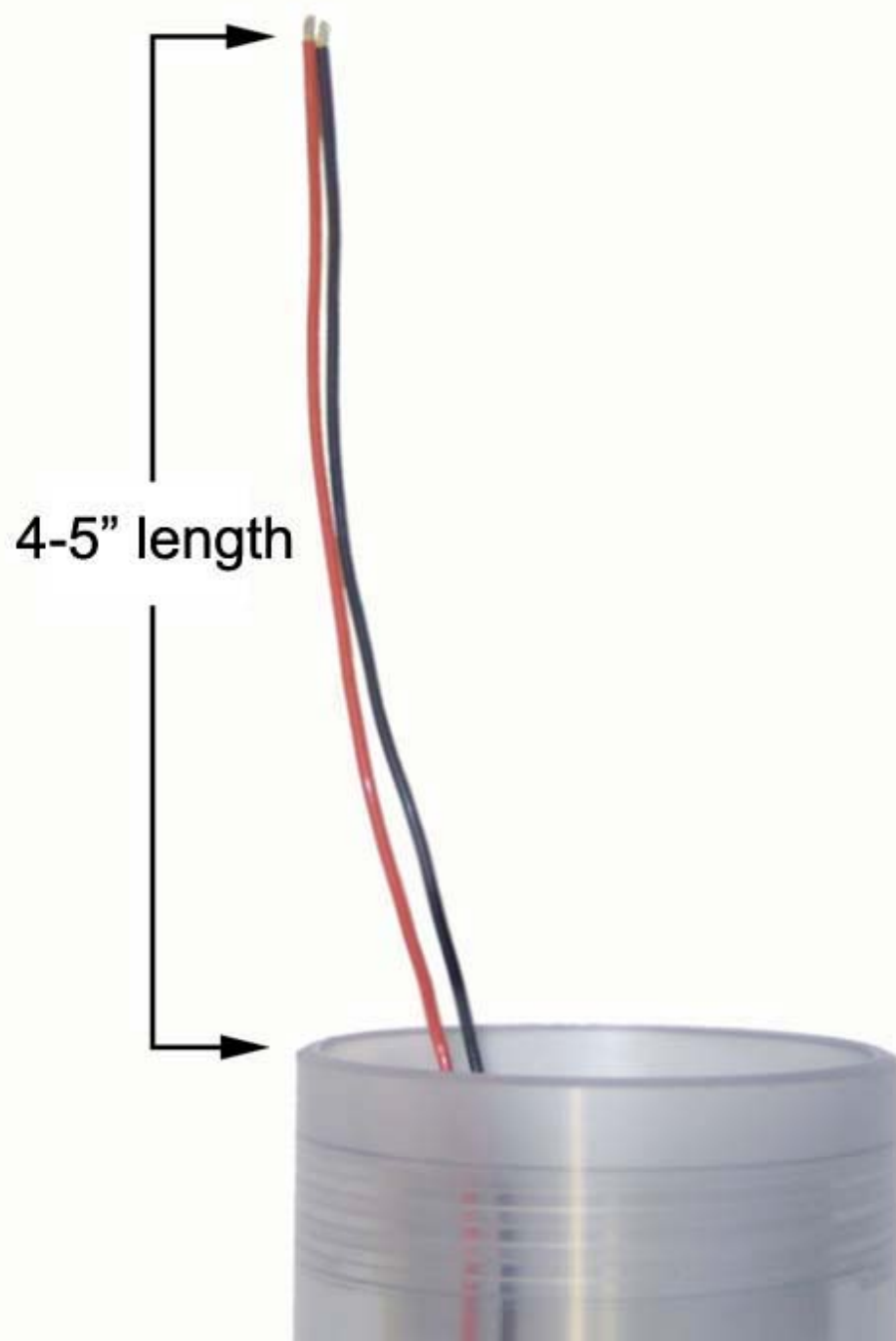

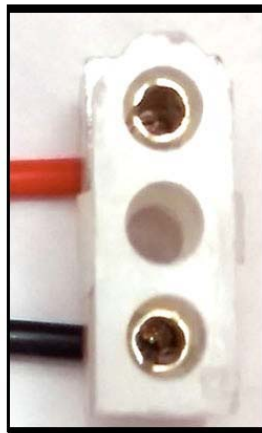

**Pin1 Red
Pin2 None
Pin3 Black**

**Male Molex Connector
Digikey P/N 03-06-1032
with Female Pin
Digikey P/N 02-06-1103**

Now troubleshoot to see if you have a good electrical connection.

Test the light by plugging the connector into a power supply or battery. If it does not light up, this may indicate the following: a bad connection between wires and pins, the wire leads may not have been stripped correctly, pins may not be in the proper holes, wires may be inserted backwards, or the pins may not be properly crimped to the wire leads.

Install the Lens and Front Lens Retainer Ring.

The following picture shows the
order of the parts.

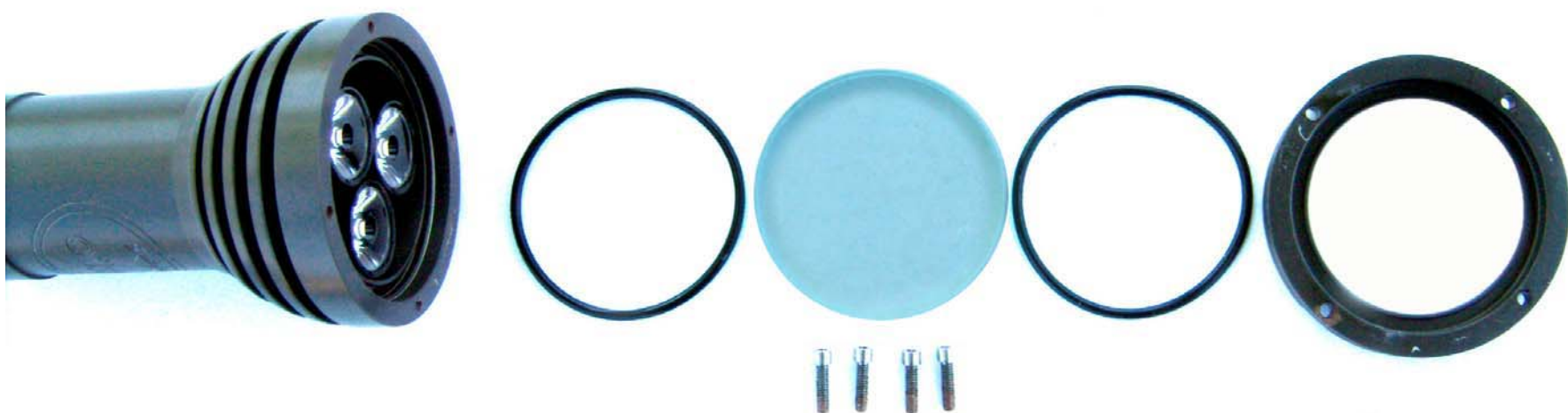



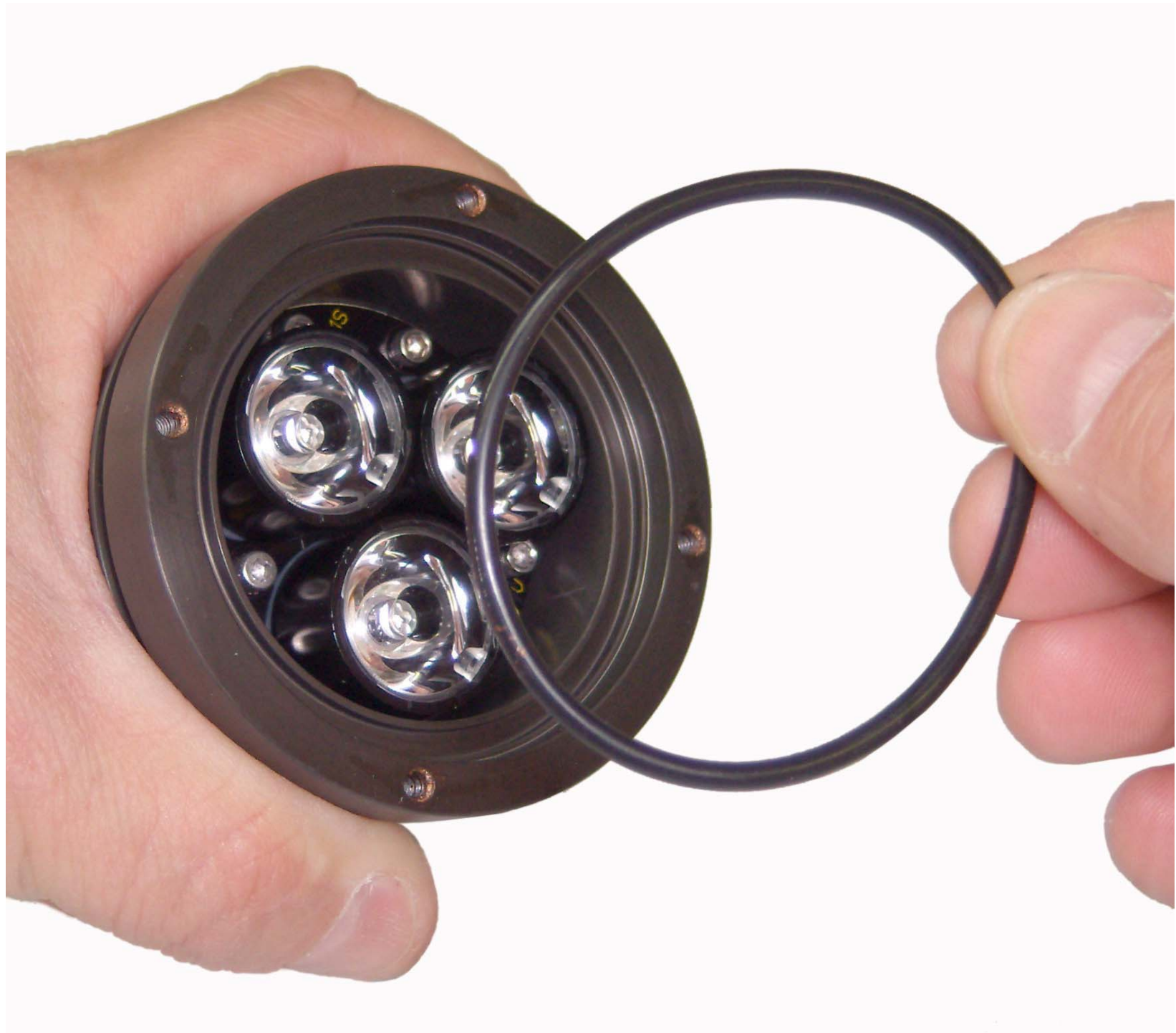





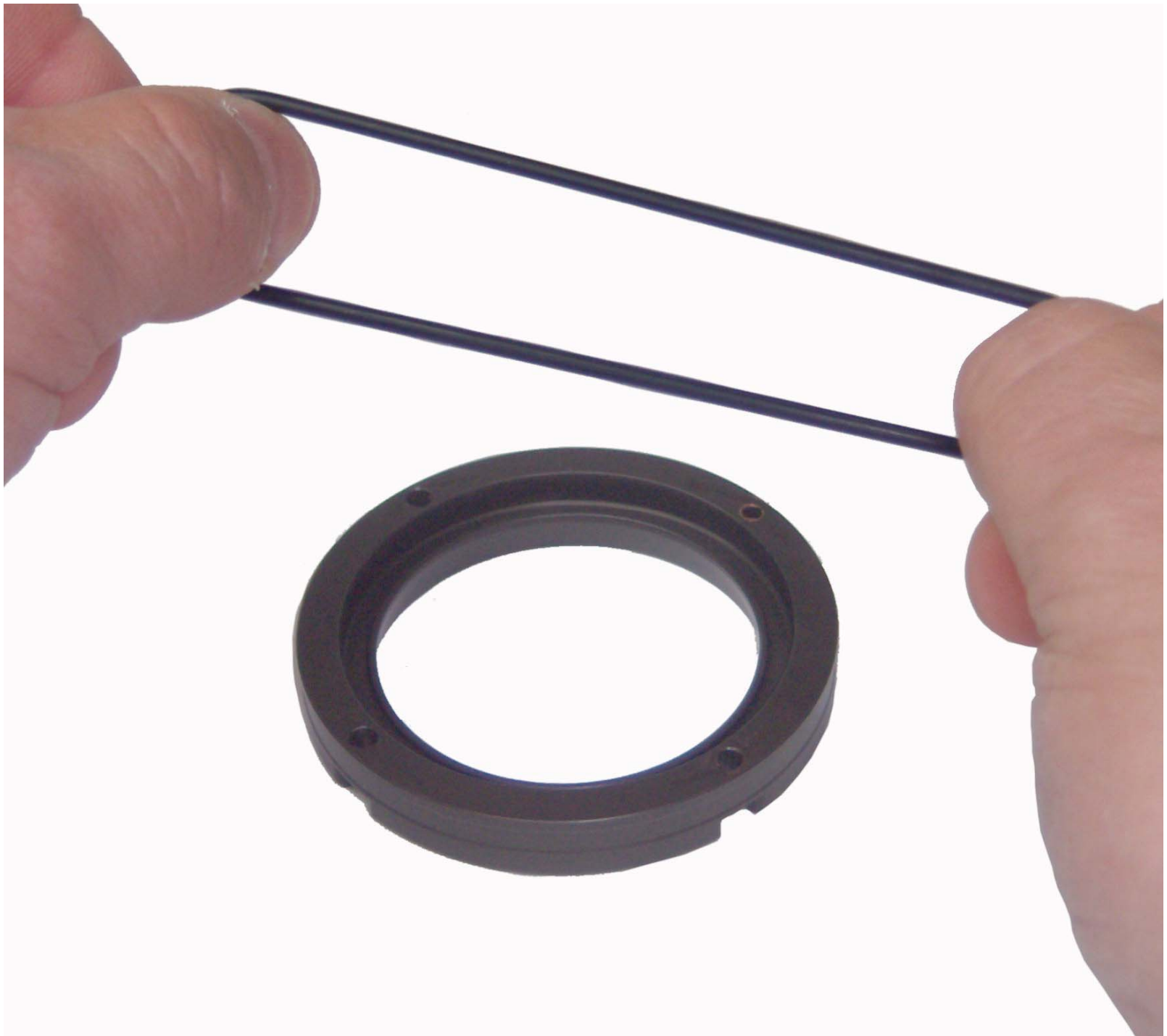











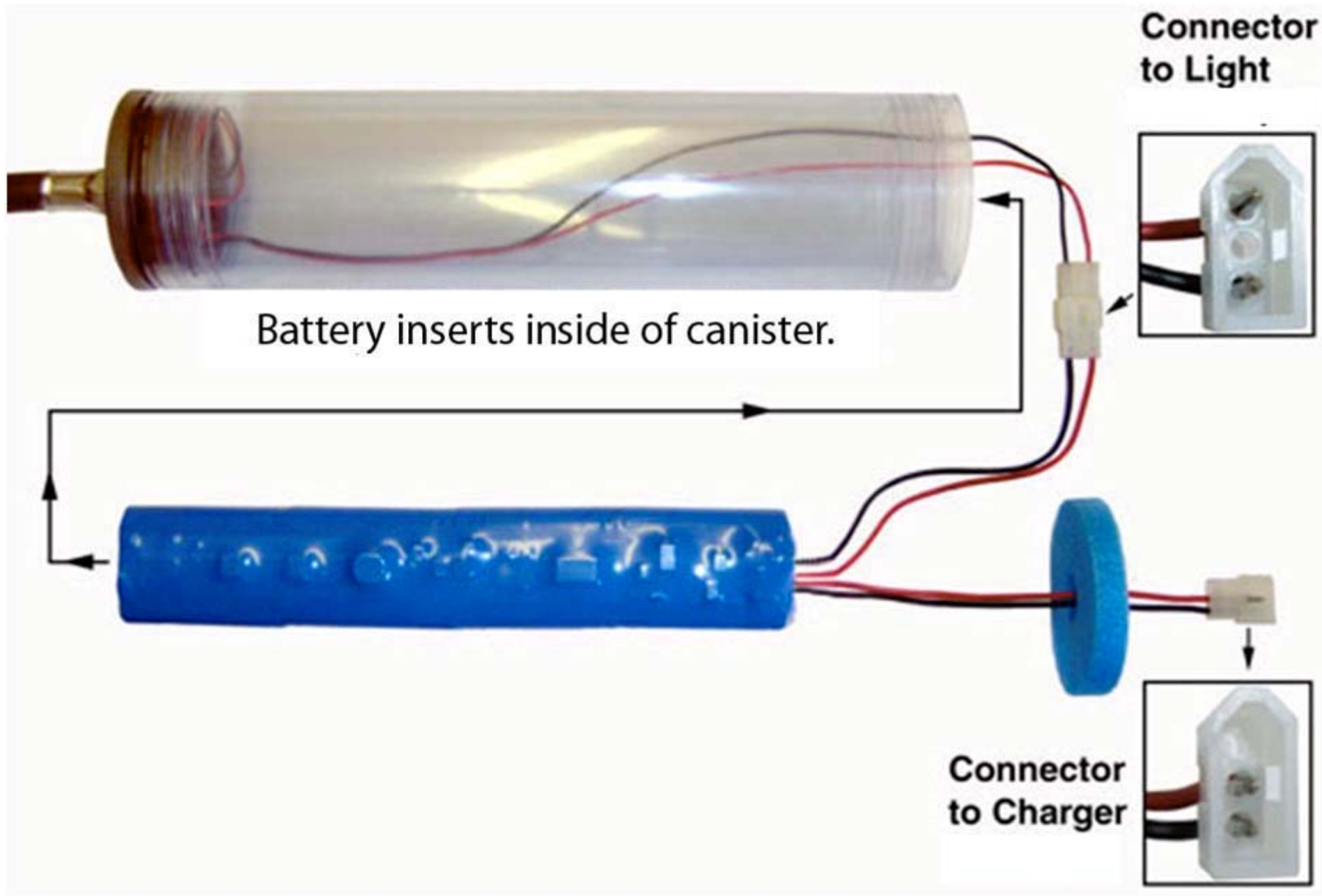

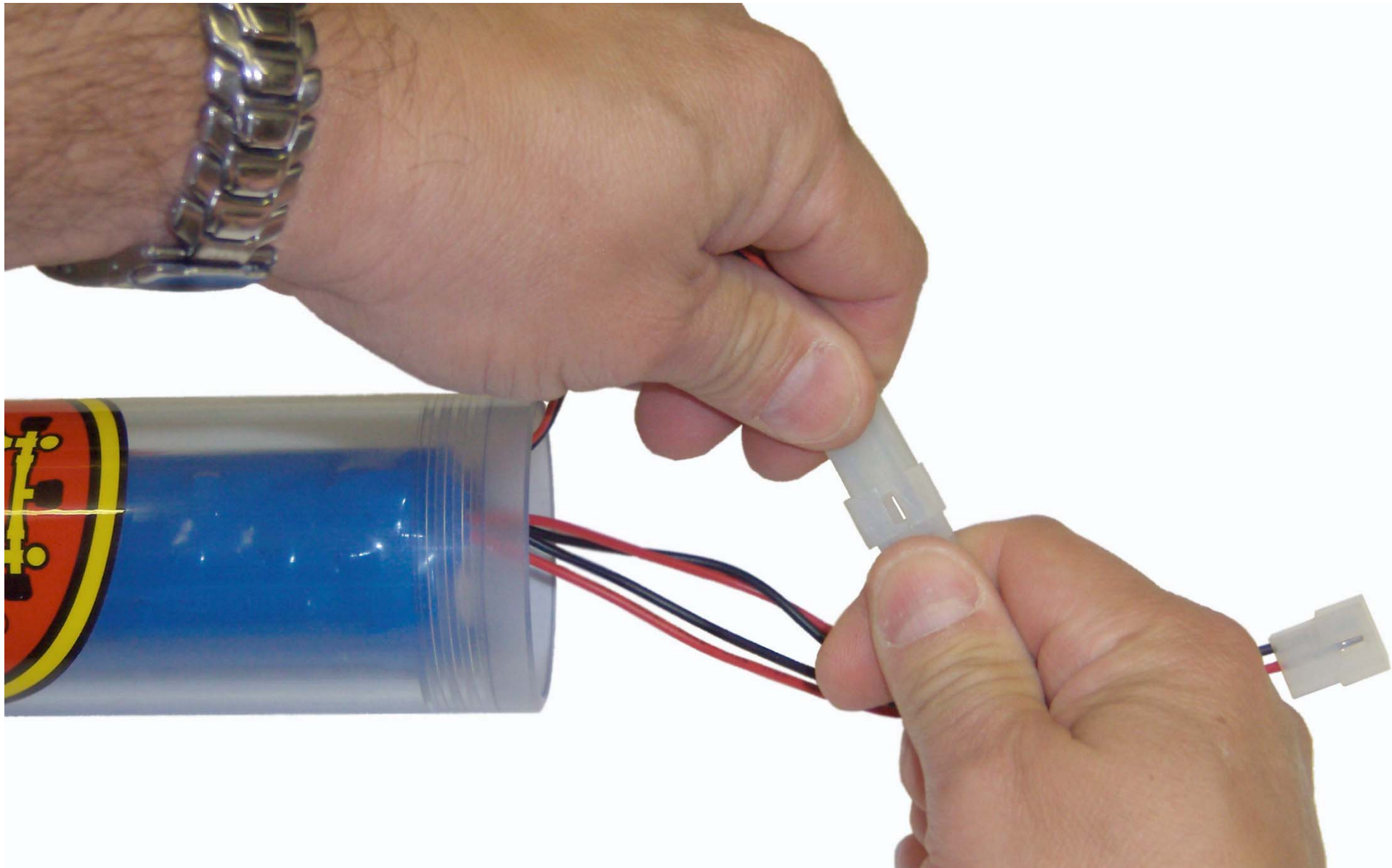











Congratulations! You have now successfully completed
assembly of your OMS L197LED3-K or L197LED20-K
PHANTOM Light!



PARTS DIAGRAM 1

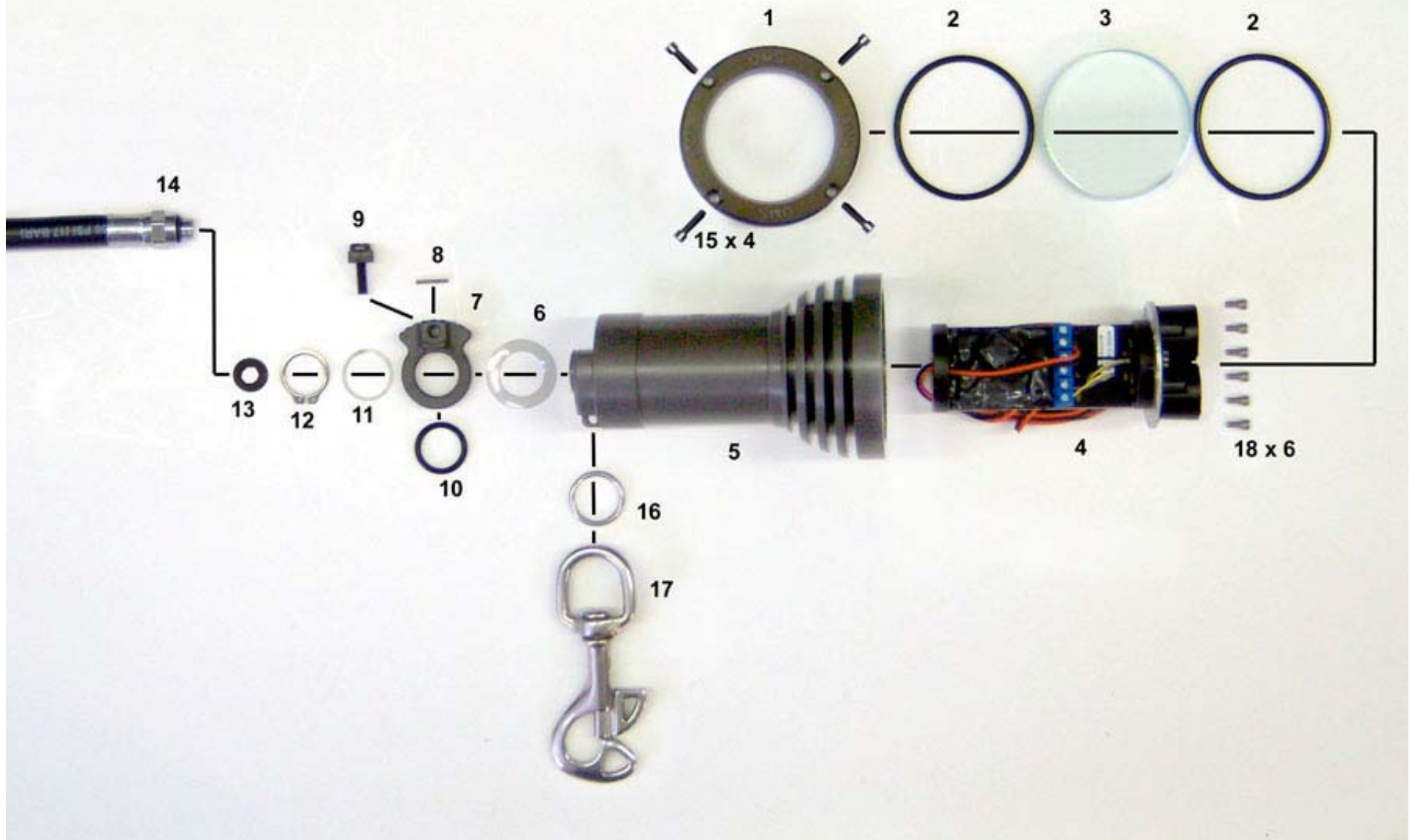

TOOLS REQUIRED

